

FAMILY pravá

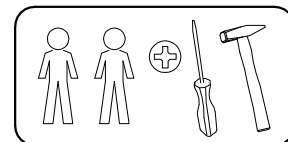

Časti sedacej súpravy :

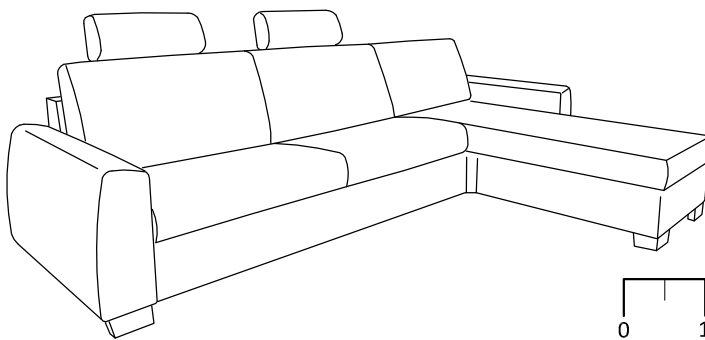
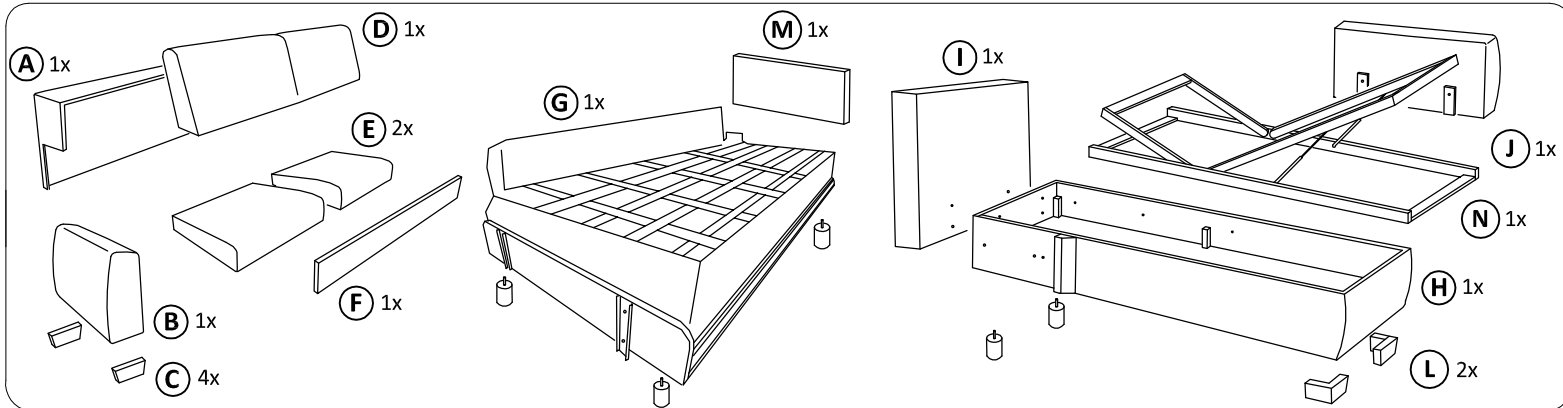

Montážne kovanie :

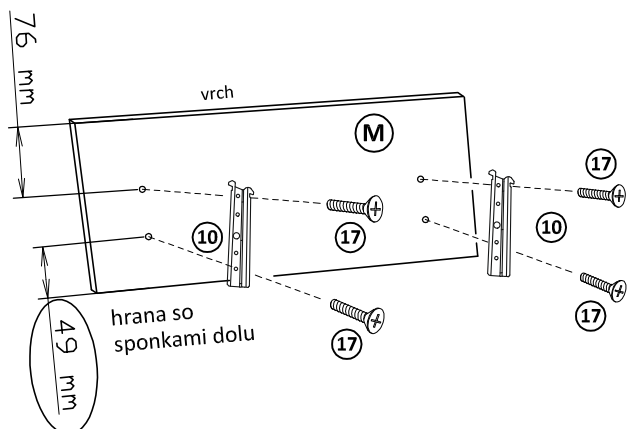
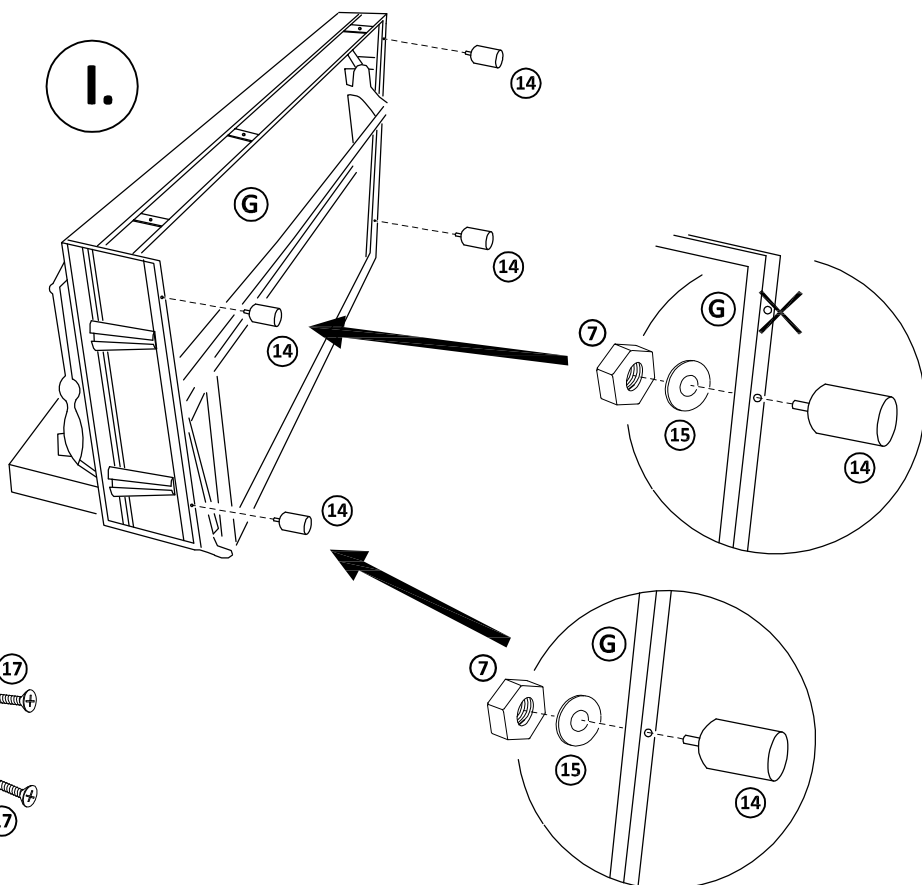

II.

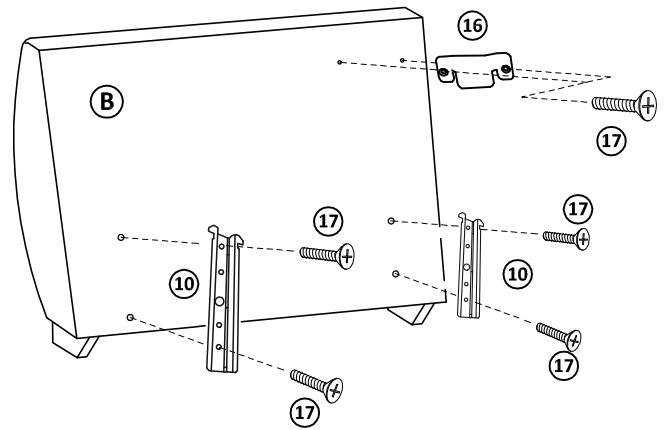
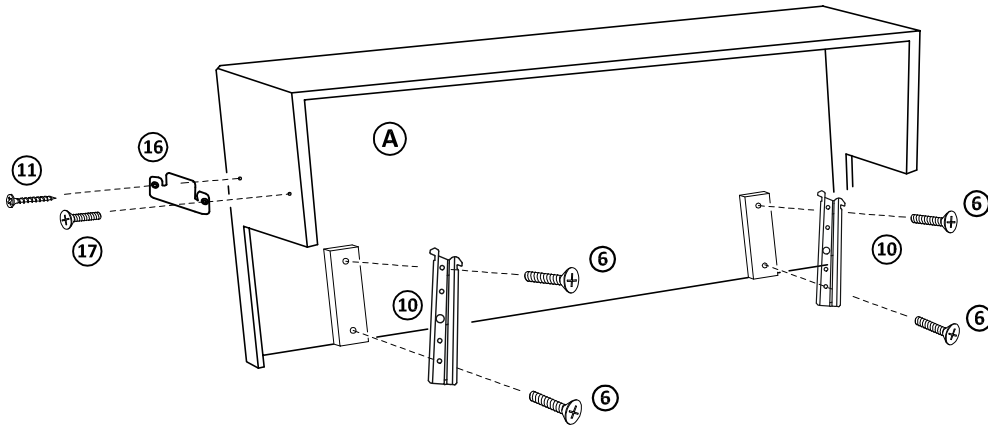
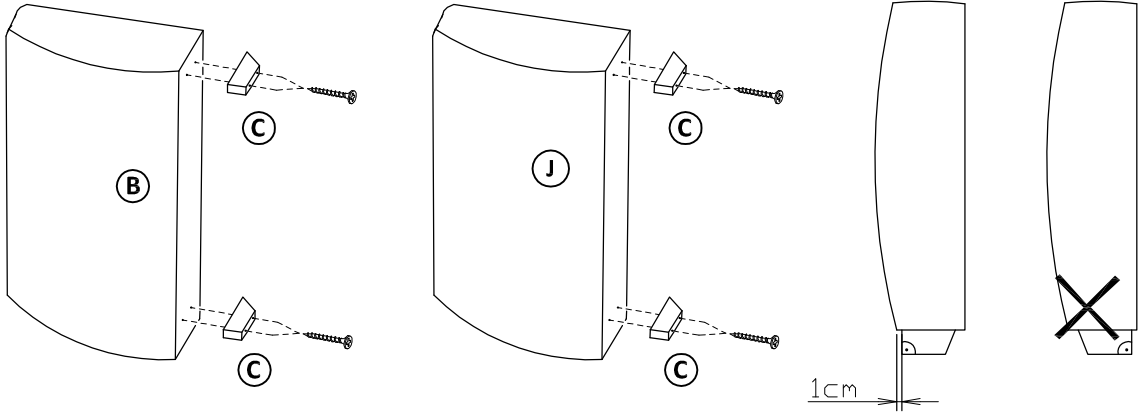

III.

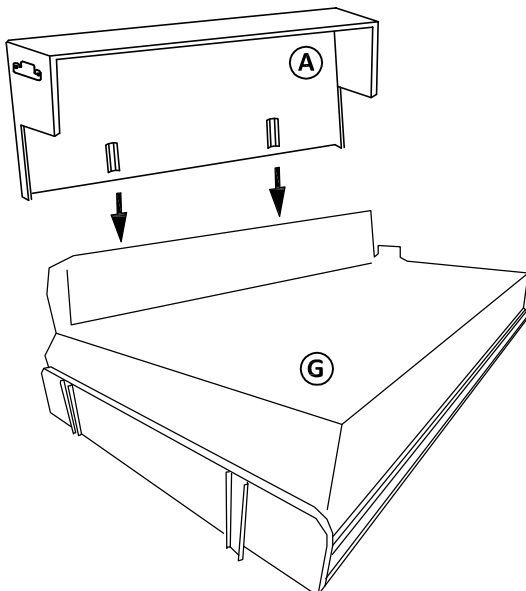

IV.

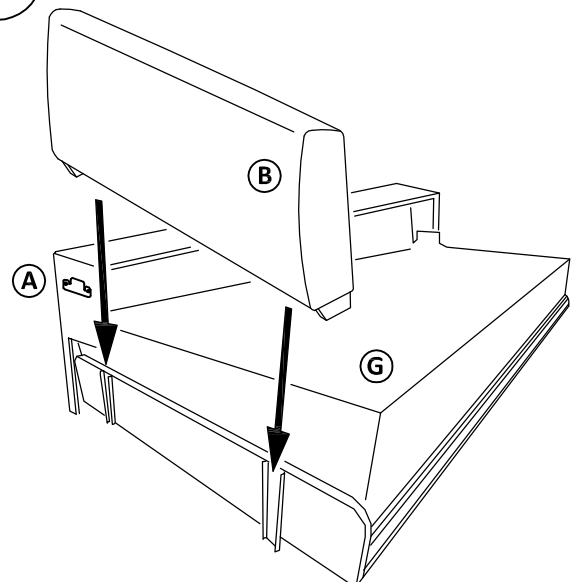

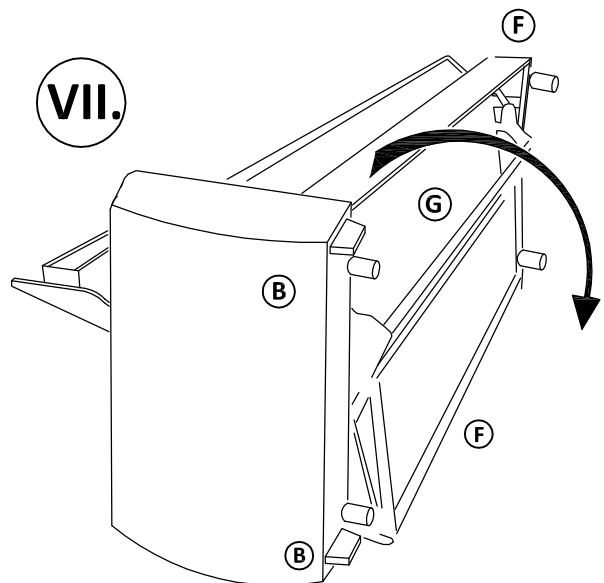
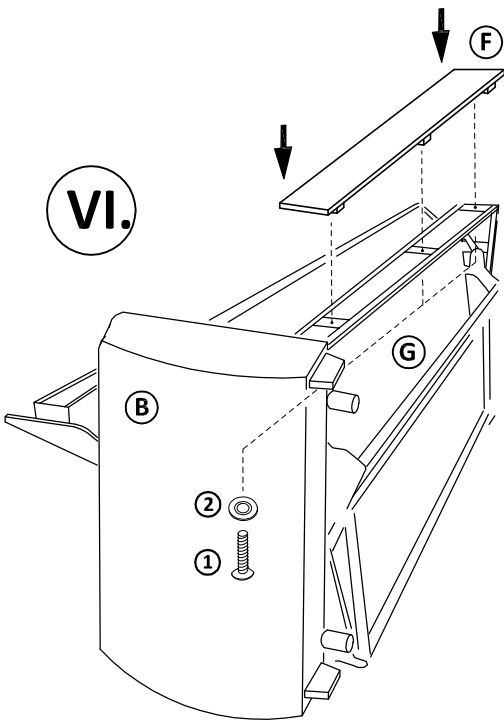
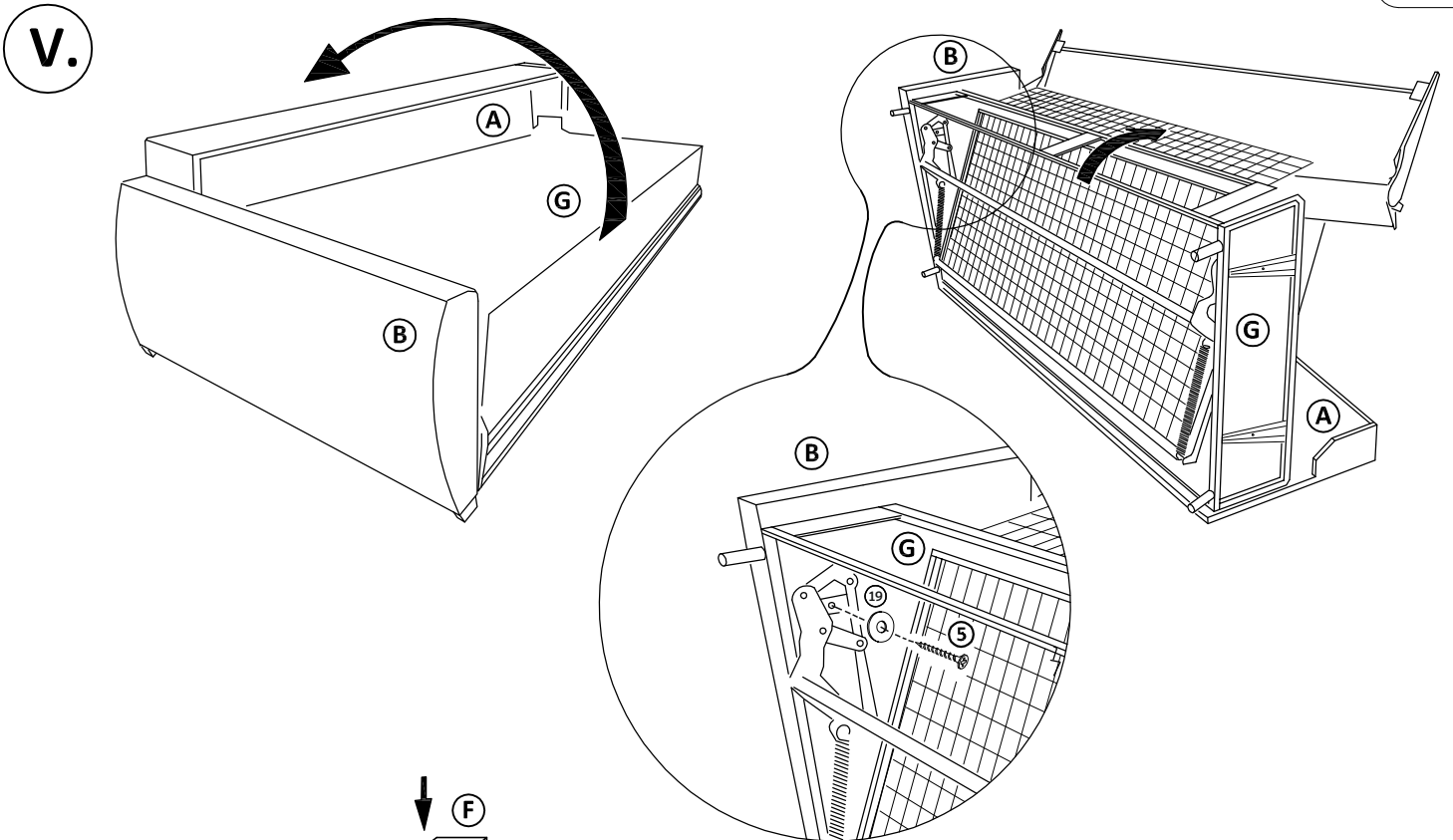

Pri preklápaní jemne pridvihnúť, aby nedošlo k vylomeniu nohy sedacej súpravy.

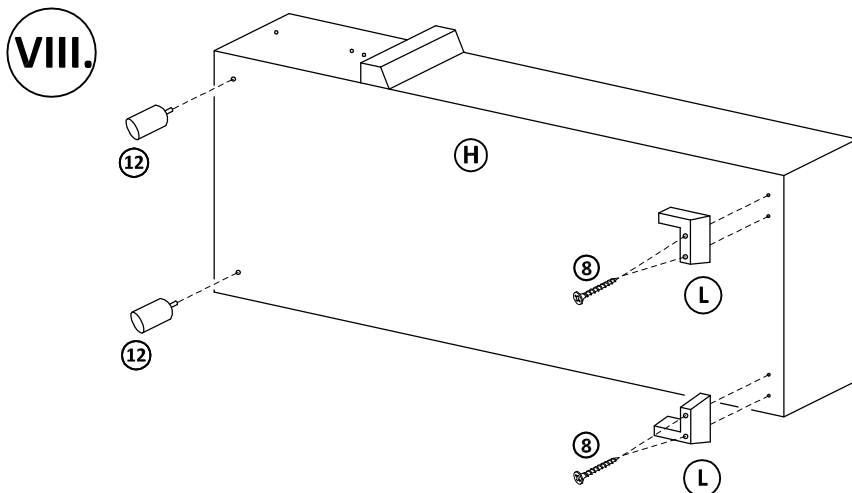

IX.

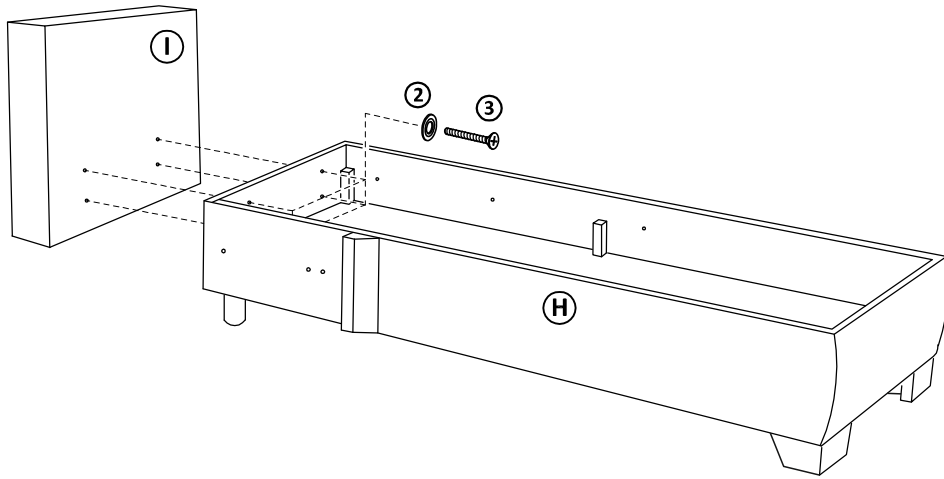

X.

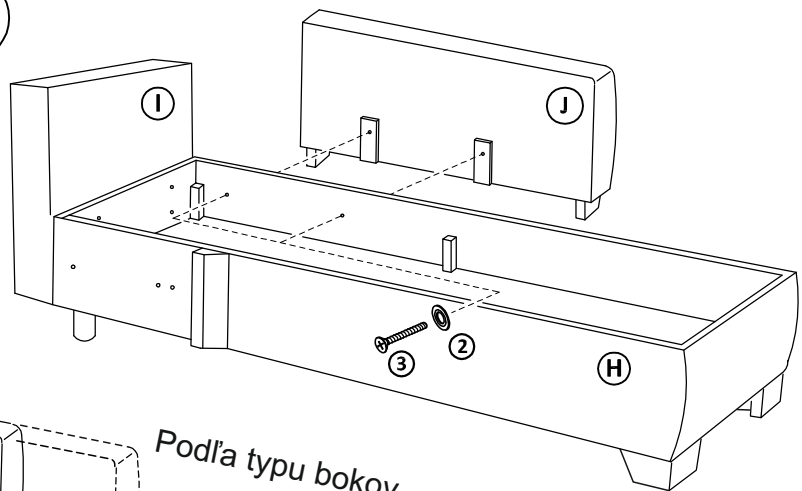

XI.

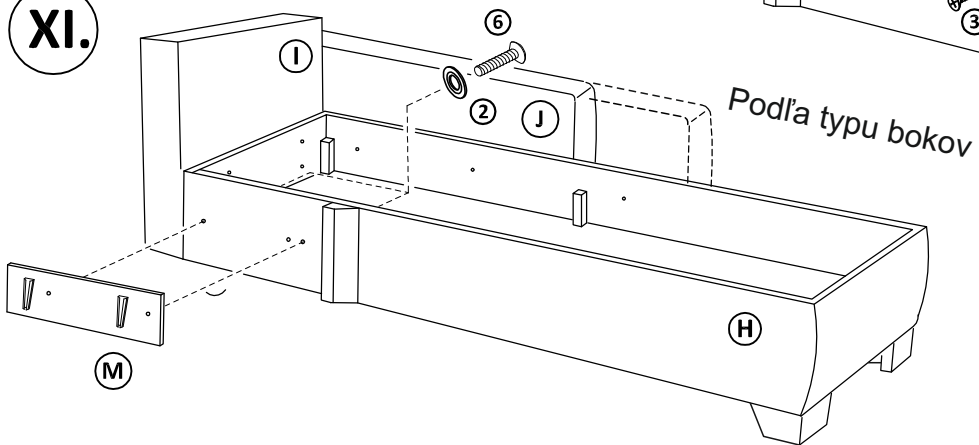

XII.

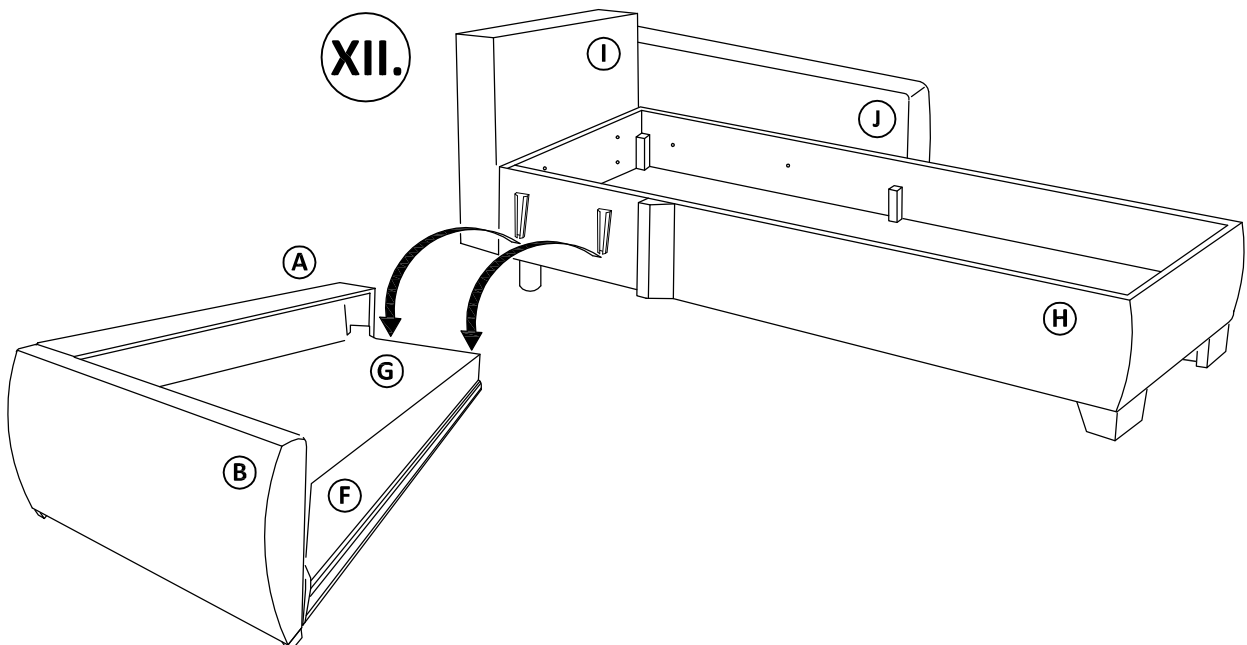

XIII.

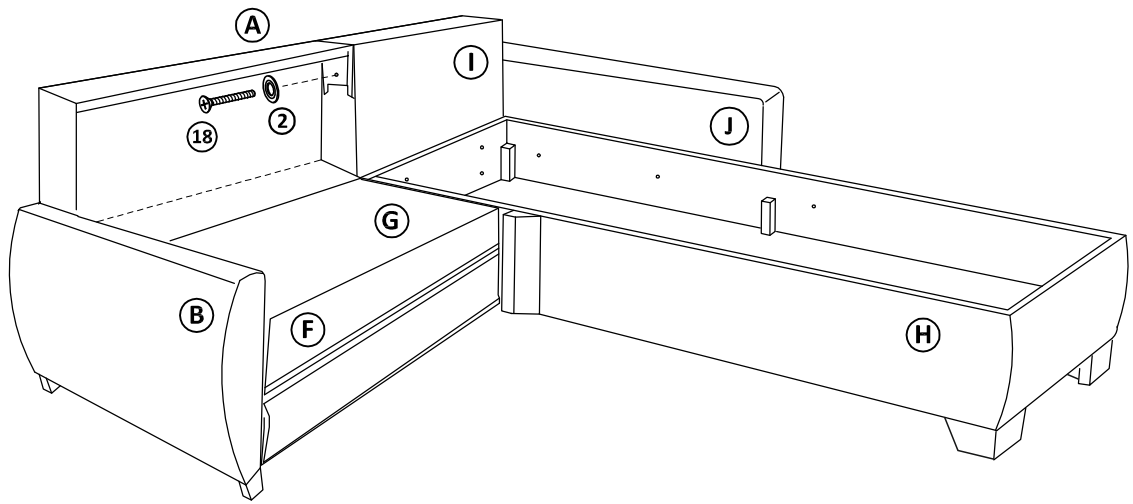

XIV.

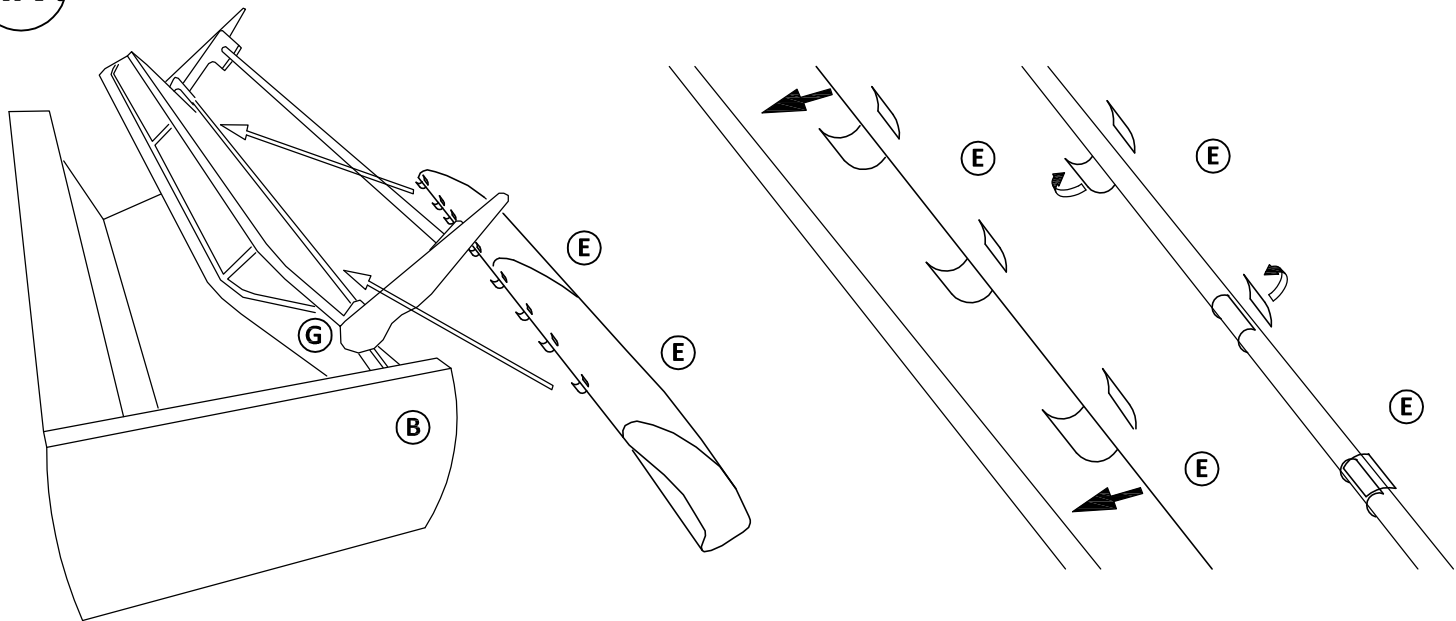

XV.

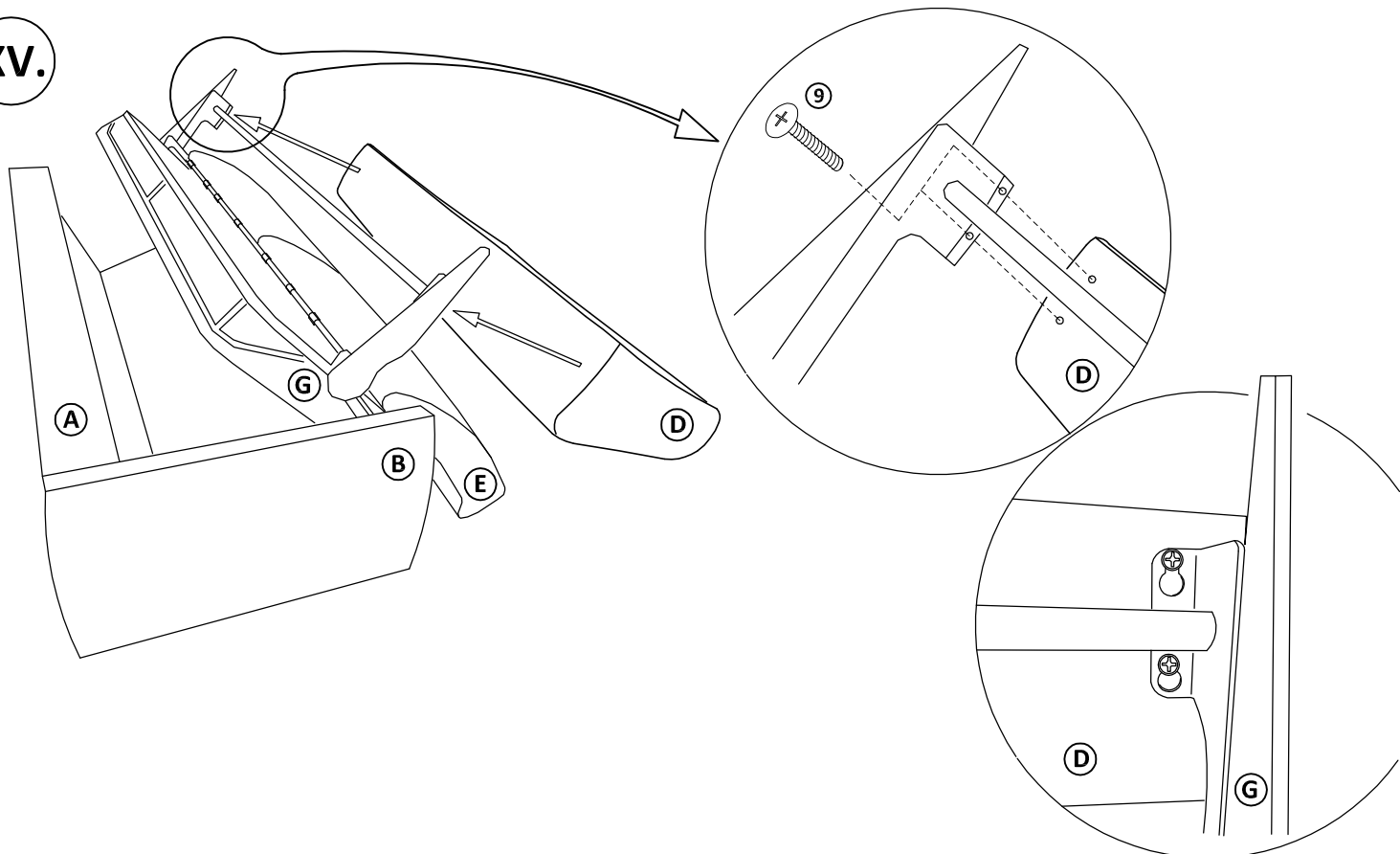

XVI.

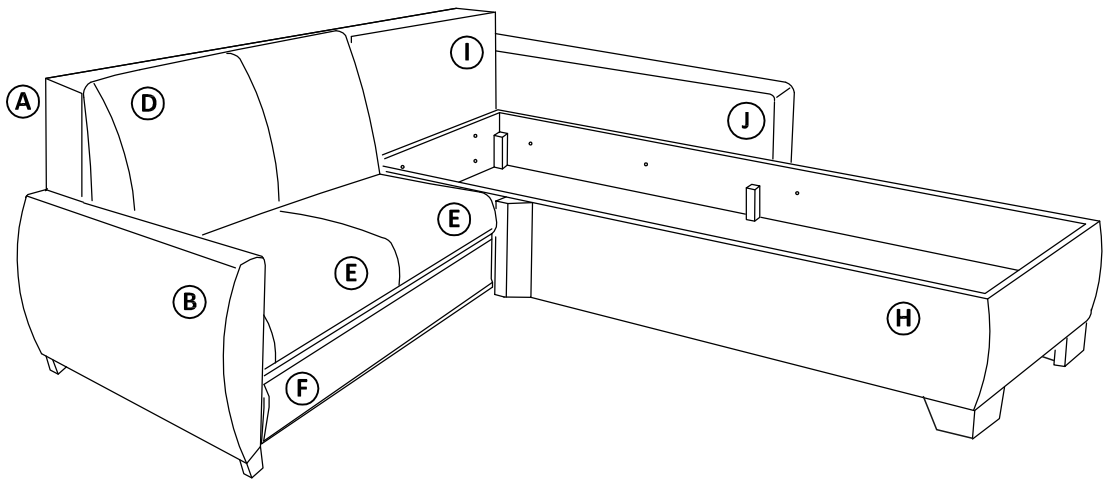

XVII.

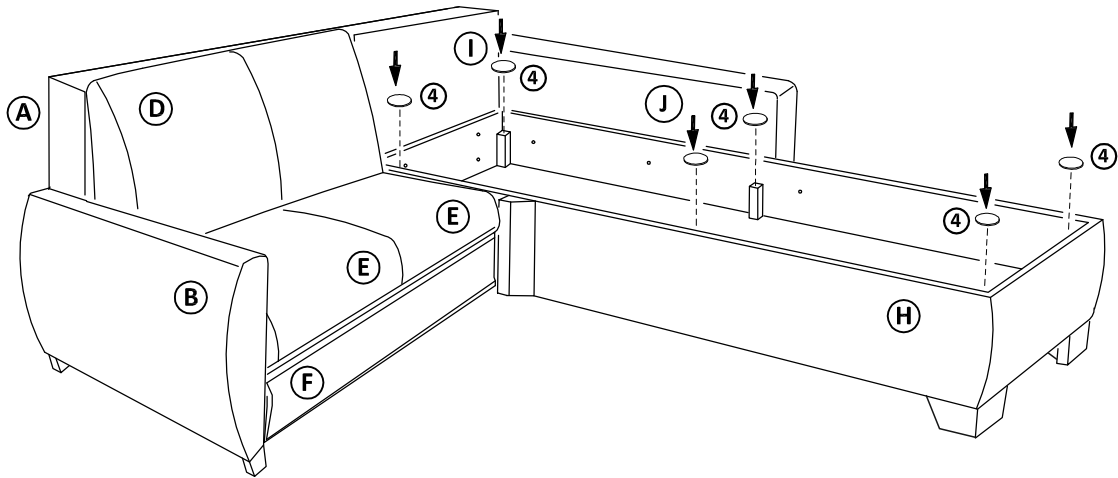

XVIII.

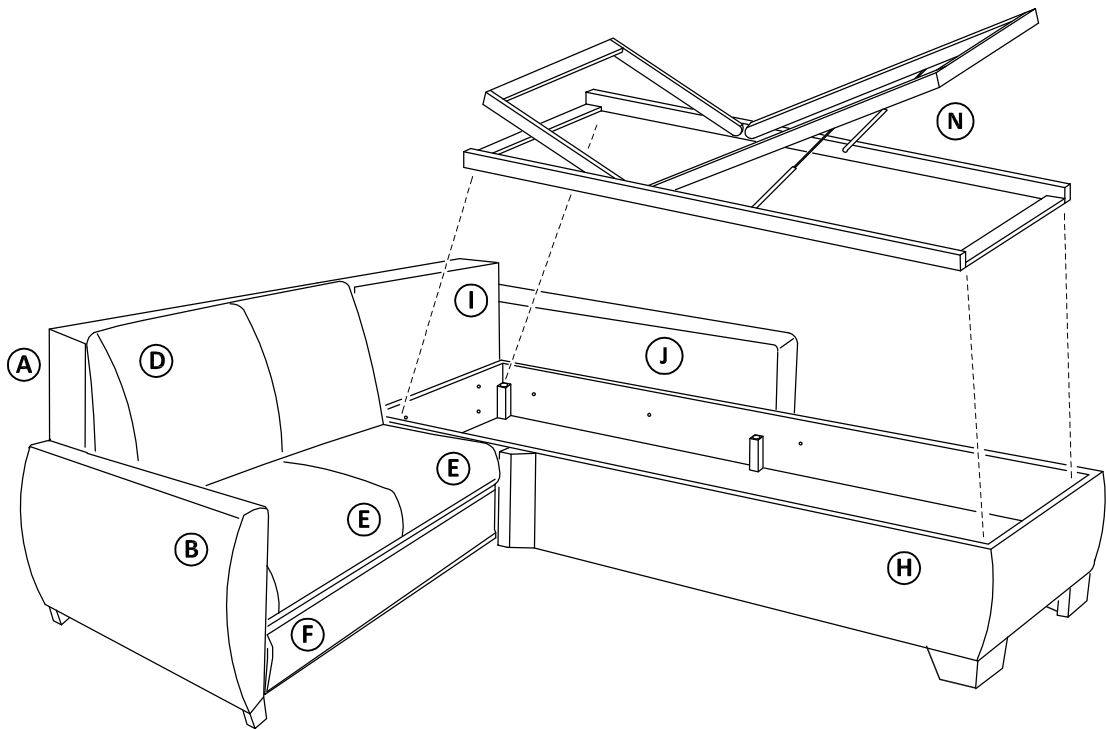

XIX.

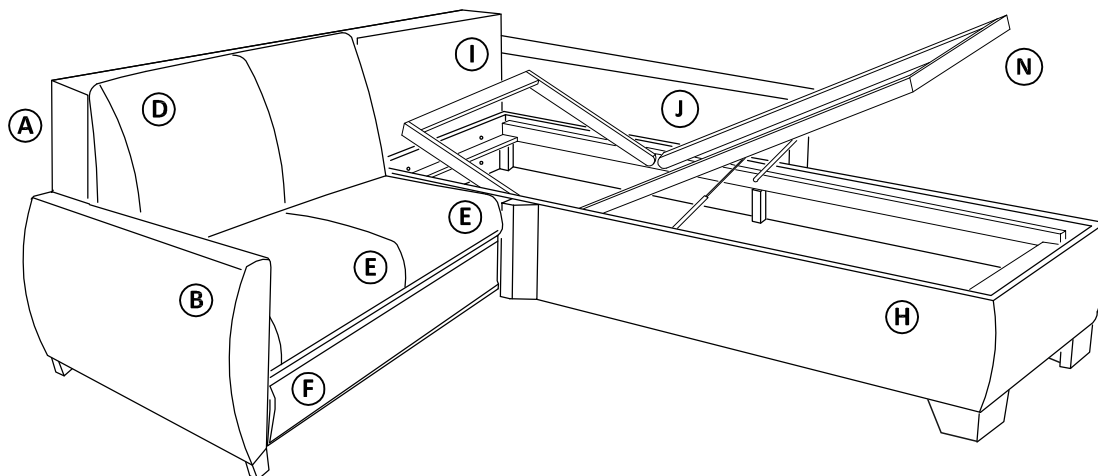

XX.

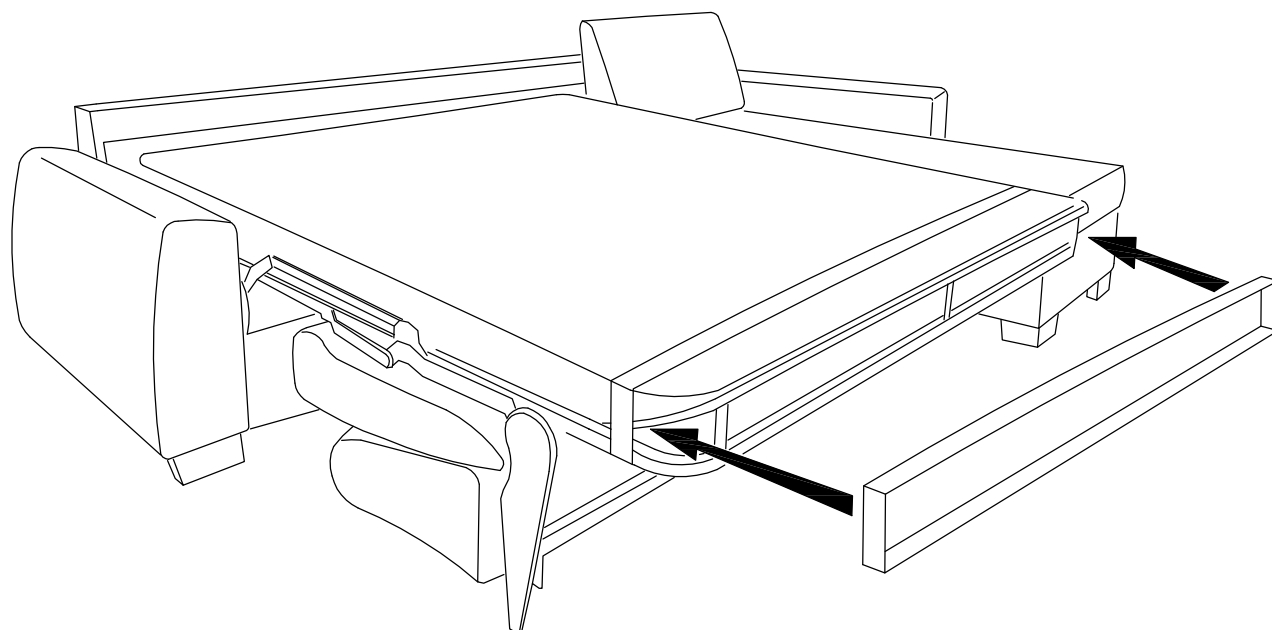
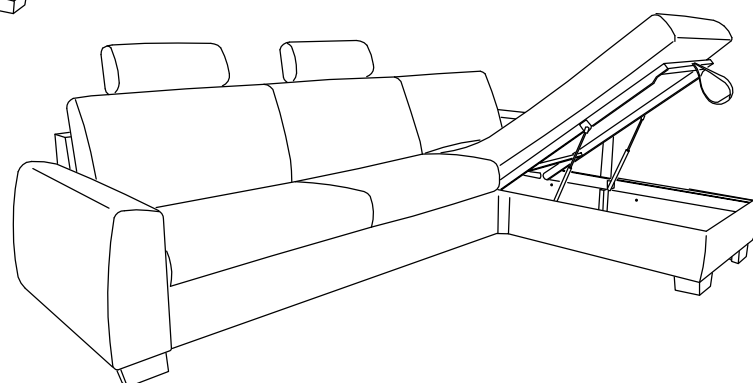
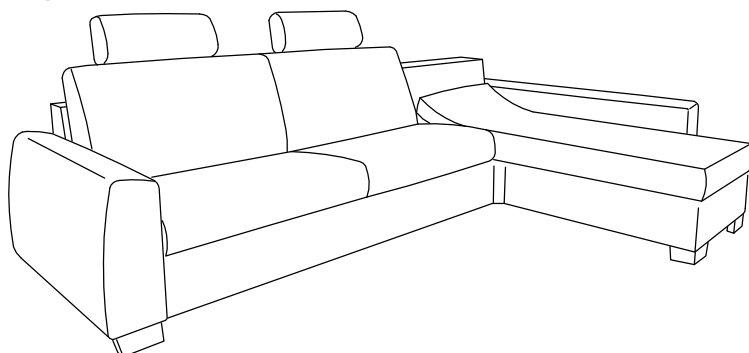

Po zmontovaní výrobku vhodte polyetylénovú fóliu a kartón do kontajnera s príslušným označením plasty/kartón

Čalúnenie sa zbavuje povrchového prachu vysávačom alebo jemnou kefou. Čalúnený nábytok nevyklepávame. Radšej čistíte častejšie, ako dopustiť veľký rozsah znečistenia. Čalúnený nábytok a jeho drevené časti nikdy nečistíme benzínom a acetónom. Čalúnený nábytok neumiestňujte na priame slnečné žiarenie.

Počas používania po polroku a potom raz do roka skontrolujte skrutky a v prípade ich uvoľnenia pevne dotiahnite. Výrobok neťahajte po podlahe, ale prekladajte.